



**mowbie™**



**Light Stimulation  
Rotary Shaver**

## Product Overview

---

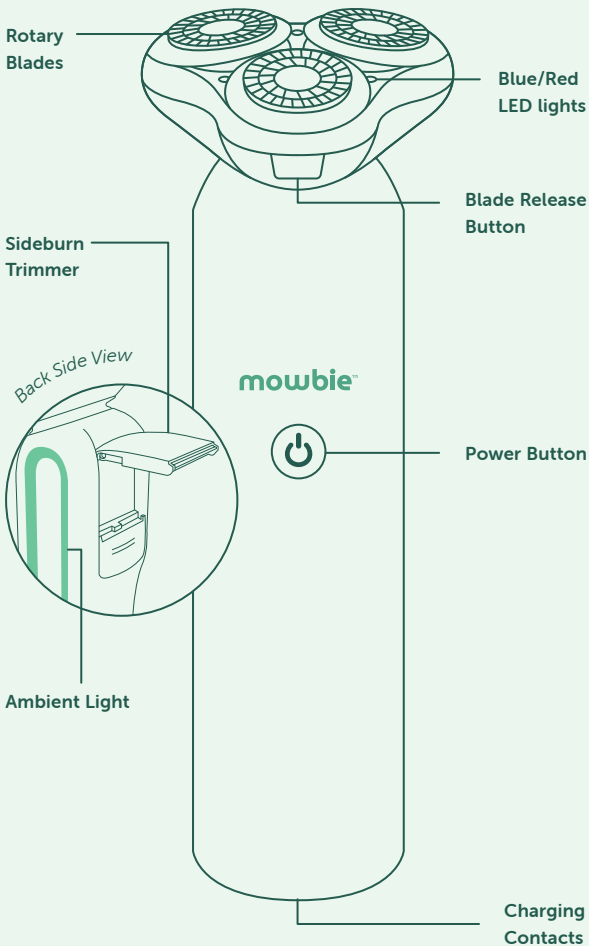

## Accessories

---

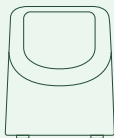

Charging Stand

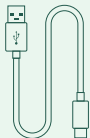

USB-C  
Charging Cable



Cleaning  
Brush

## Warnings

---

- Do not expose to water when charging.
- This device is not a toy and is not intended for use by or on children.
- This device is intended for household use only.
- Do not use the device if it appears damaged, as injury may occur.
- Do not use on injured or damaged skin.
- Keep longer hair and clothing away from product during use.
- Do not share with others, this device is for personal use only.
- Stop use immediately if skin becomes irritated or inflamed.

## Eye Safety Warnings

---

The device is designed so that the Blue and Red lights will only turn on when in contact with your skin or another surface. Do not place the LEDs directly over the eyes or eyelids, or attempt to look directly into the LEDs at full strength. The LEDs can be damaging to your eyes if you stare directly at them.

## How to Charge

---

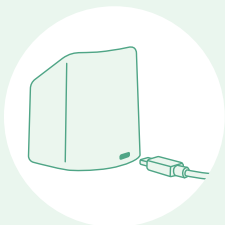

The power button on the device will turn red and the ambient LEDs will dim to indicate that the battery is low. To charge the rotary shaver, plug the USB-c charging cord into the back of the charging stand. Use with a 5-volt USB wall adapter (standard mobile phone charger).



Then, place the device in the charging stand so the bottom charging contacts on the device line up with the contacts on the charging stand. When charging, the power button and the ambient LED lights on the side of the device will pulse. Once the device is fully charged, the power button and the LED lights will turn off.

*A full charge will take 165 mins. and provide approximately 50 mins. of operation.*

## How to Use

---

**Standard Mode:** *For a close, comfortable shave without any additional LED light stimulation.*

1. Press the power button once to turn the device ON. The rotary shaver blades will activate.
2. Begin shaving by gently pressing the shaver against the skin and moving it in circular motions. It may help to pull the skin taut with one hand to get the closest shave.
3. Press the power button three more times to cycle through the other modes and turn the device OFF.

## How to Use (cont.)

---

**Blue Light Mode:** *Blue LEDs stimulate the skin while shaving to help reduce mild to moderate acne.*

1. Press the power button twice to turn the device ON, cycle past Standard Mode and enter Blue Light Mode. The rotary shaver blades will activate and the blue LEDs will illuminate dimly.
2. The device uses a sensor to detect when the shaver is in contact with your skin. When you hold the shaver to your face, the blue LEDs will illuminate at full intensity.
3. Gently press the shaver against the skin and move in slow circular motions to shave your face and simultaneously gain the benefits of Blue Light stimulation.
4. It's recommended to keep the device in the same area for 3 minutes at a time for maximum benefits of the Blue Light.
5. Press the power button twice more to cycle past the other mode and switch the device OFF.

**Red Light Mode:** *Red LEDs stimulate the skin while shaving to help reduce the appearance of wrinkles and fine lines.*

1. Press the power button three times to cycle past the other modes and enter Red Light Mode. The rotary shaver blades will activate and the red LEDs will illuminate dimly.
2. The device uses a sensor to detect when the shaver is in contact with your skin. When you hold the shaver to your face, the red LEDs will illuminate at full intensity.
3. Gently press the shaver against the skin and move in slow circular motions to shave your face and simultaneously gain the benefits of Red Light stimulation.

## How to Use (cont.)

---

4. It's recommended to keep the device in the same area for 3 minutes at a time for maximum benefits of the Red Light.
5. Press the power button once more to switch the device OFF.

**Trimmer Mode:** *To shave and clean the edges of your facial hair.*

1. To extend the sideburn trimmer, slide the button on the back of the device down, allowing the trimmer to pop up.
2. Press the power button once to turn the trimmer ON. Gently press the trimmer against the skin and move in the direction needed to shape and clean up your sideburns or mustache.
3. Press the power button three more times, cycling through the light treatment settings, to turn the trimmer OFF.

## Blade Replacement

---



### **Step 1:**

Turn the shaver OFF before replacing the rotary blades. Press the 'blade release button' on the front of the shaving unit to open the shaving unit.

## Blade Replacement (cont.)

---



### Step 2:

Detach the shaver head from the shaving unit by gently pulling it away from the device.

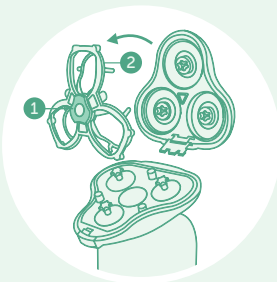

### Step 3:

Turn the cutter lock (1) counterclockwise and pull the blade holder frame (2) away from the device.

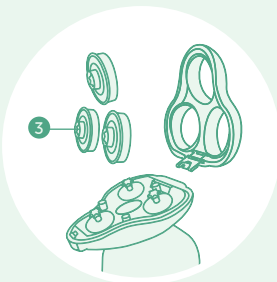

### Step 4:

Remove old the rotary blades (3) and place new rotary blades in the shaver head.

## Blade Replacement (cont.)

---



### Step 5:

Replace the blade holder frame (2) and turn the cutter lock (1) clockwise. Then push the shaver head back into the shaver unit.



### Step 6:

Close the shaving unit.

## Cleaning

---

1. Turn shaver OFF before cleaning.
2. Press the 'blade release button' on the front of the shaving unit to open the shaving unit.
3. Clean inside the hair chamber and behind the rotary blades by rinsing them under water and/or by using the cleaning brush.
4. Close the shaving unit and gently shake off excess water.



## Cleaning (cont.)

---

5. Open shaving unit again and leave open to air dry.
6. To clean the sideburn trimmer, rinse under water and/or use the cleaning brush. Set aside to air dry.

## Warranty

---

The mowbie™ light stimulation rotary shaver carries a warranty against manufacturing defects (excluding cutting blades) for two years from the date of original purchase. mowbie will, at our option and upon submission of a valid proof of purchase within the warranty period, repair or replace the shaver free of charge. For assistance or for issues related to performance, damages, blade replacement, warranty, regular maintenance or customer feedback, please contact mowbie Toll Free at (800) 514-2546 (except in Massachusetts) or in Massachusetts at (781) 449-9500 - press zero for an operator and request assistance or visit [mowbie.com](http://mowbie.com), Monday - Friday from 8:30AM until 5:30PM EST.



**Enjoy Your Shave!**

More questions? Visit [mowbie.com/support](http://mowbie.com/support)

# iykym



mowbie



“if you know,  
you mow”